

FireLock® Fire-Pac

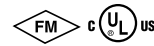

SEE VICTAULIC PUBLICATION 10.01 FOR DETAILS

SERIES 745

The Victaulic FireLock Series 745 Fire-Pac is a completely pre-assembled fire protection valve with trim and all optional components enclosed in a metal cabinet.

The Series 745 Fire-Pac is cULus Listed and FM Approved. All electrical enclosures and connections are UL Listed, and all materials and wiring conform to NFPA requirements.

Available in 1½ through 6¾/40 - 150 mm sizes, the FireLock Fire-Pac can incorporate any of the following available valve configurations:

- **Dry – Actuated and/or Accelerated**
- **Deluge – Wet pilot, dry pilot, and electric actuation**
- **Preaction – Non-interlock, Single Interlock, and Double-Interlock**
- **Preaction – AutoConvert preaction to dry**

Included in the FireLock Fire-Pac are a water supply shutoff valve, the sprinkler system fire protection valve, alarm line pressure switches, air supervisory pressure switches, supervisory pump switches, and pressure gauges that are easily viewed through a window in the cabinet door.



If required, the system can be supplied with an additional shutoff valve installed above the sprinkler system fire protection valve. This additional shutoff valve can provide greater system integrity during trip tests. NOTE: All shutoff valves are pre-wired for supervisory alarms.

The manual pull station, mounted on the front of the Fire-Pac cabinet, is accessible through a supervised door. Once the door to the manual pull station is opened, the valve can be manually tripped.

When system air pressure is required, a compressor can be supplied with an optional air tank and air maintenance device for complete system integration.

The system control panel is part of the cabinet door assembly for easy access and visibility. All electrical connections from inside the Fire-Pac to the control panel are pre-wired. All external electrical connections are accessible through an enclosure on the outside of the cabinet.

The standard releasing panel is the Model PDRP-2001, a compact single enclosure, containing the power supply, standby batteries and a battery charger as well as connections for the detectors, waterflow and tamper switches, and the solenoid valve. The Model PDRP-2001 is software-programmed for field setting as two area or single area cross-zoned control. Mounting slots are provided for optional module boards.

For ease of installation, all pipe connections use Victaulic FireLock grooved pipe couplings and fittings. The water supply and drain can be connected from either side of the cabinet.

For proper system setup and maintenance, please refer to the Victaulic I-745 installation, maintenance, and testing manual. All electrical component literature is included with the Fire-Pac cabinet.

For complete fire protection valve information, request submittals:

- 30.80 – Series 768 FireLock NXT™ Dry Valve
- 30.81 – Series 769 FireLock NXT Deluge Valve
- 30.82 – Series 769 FireLock NXT Preaction Valve

WARNING

- The FireLock Fire-Pac must be installed and maintained in accordance with the installation, maintenance, and testing manual for the fire protection valve.
- Installation must conform to NFPA standards and any additional requirements of the local authority having jurisdiction.
- The owner is responsible for the proper maintenance of the fire protection system.

JOB/OWNER

System No. _____
 Location _____

CONTRACTOR

Submitted By _____
 Date _____

ENGINEER

Spec Sect _____ Para _____
 Approved _____
 Date _____

FireLock® Fire-PacSERIES 745

MATERIAL SPECIFICATIONS**CABINET SPECIFICATIONS:****Cabinet:** Steel, 12 gauge - Modular Construction (removable back and side panels for service access)**Finish:** Red – Electrostatically applied polyester powder**DEVICE SPECIFICATIONS:****Body:** Ductile iron, ASTM A-536 Grade 65-45-12**Clapper:** Aluminum bronze UNS-C95500**Shafting:** Shafts are 17-4 stainless steel**Latch:** Aluminum bronze UNS-C95500**Seat Seal:** EPDM, ASTM D2000**Seals:** Nitrile**Springs:** Stainless steel (300 Series)

FireLock® Fire-Pac

SERIES 745

DIMENSIONS FOR FIRE-PAC CABINETS CONTAINING 1 ½ – 2-INCH/48.3 – 60.3-MM VALVE SIZES

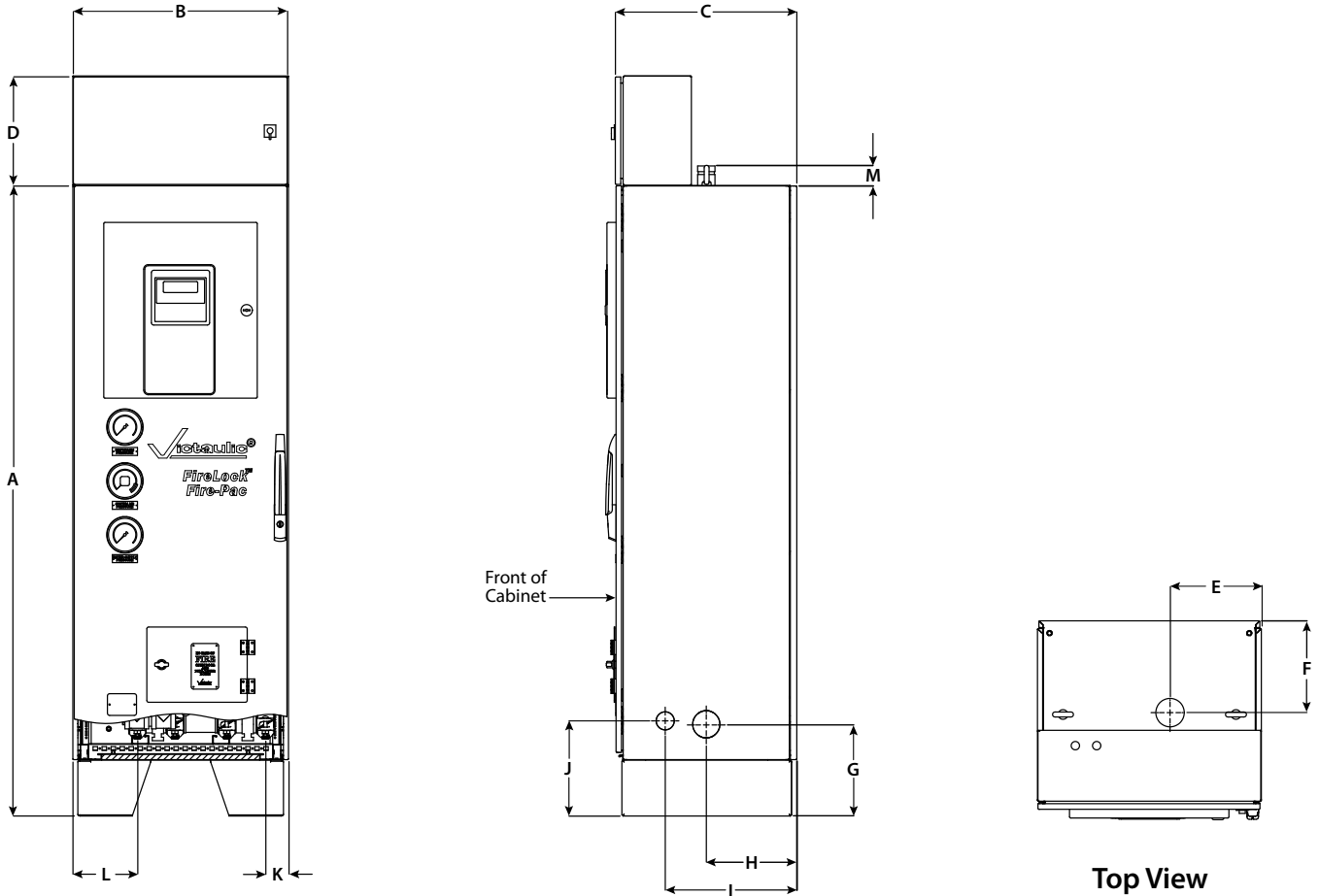

Valve Size		Dimensions – inches/mm													Approximate Weight Each lbs/kg
Nominal Size inches/mm	Actual Outside Diameter inches/mm	Height A	Width B	Depth C	D	E	F	G	H	I	J	K	L	M	
1 ½	1.900	69.11	23.62	19.89	12.00	9.63	9.69	10.05	9.92	14.42	10.43	2.52	7.06	3.00	350.0
40	48.3	1755.4	599.9	505.2	304.8	244.6	246.1	255.3	252.0	366.3	264.9	64.0	179.3	76.2	158.8
2	2.375	69.11	23.62	19.89	12.00	9.63	9.69	10.05	9.92	14.42	10.43	2.20	7.56	3.00	360.0
50	60.3	1755.4	599.9	505.2	304.8	244.6	246.1	255.3	252.0	366.3	264.9	55.9	192.0	76.2	163.3

FireLock® Fire-Pac

SERIES 745

DIMENSIONS FOR FIRE-PAC CABINETS CONTAINING 2 ½ – 6-INCH/73.0 – 168.3-MM VALVE SIZES

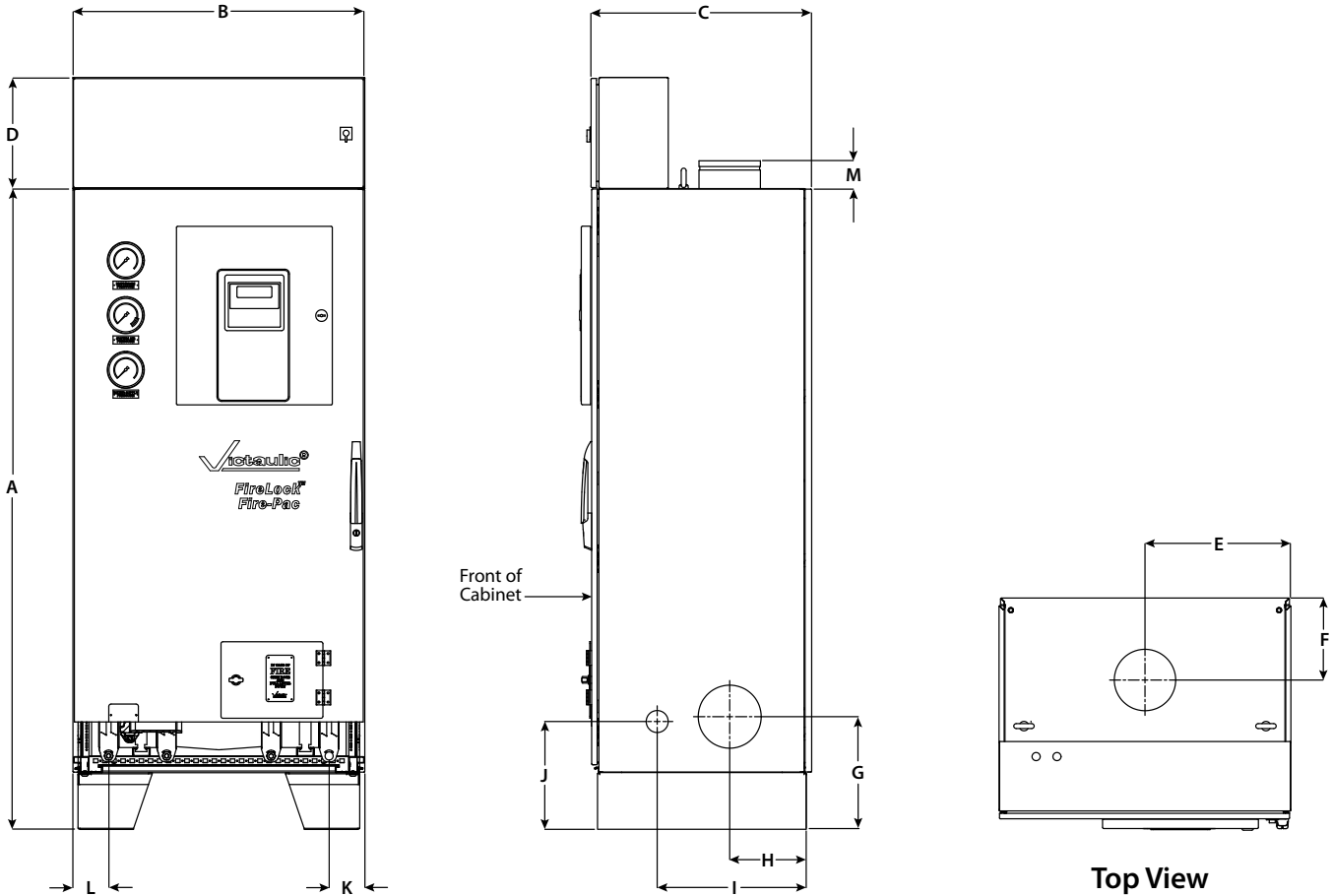

Valve Size		Dimensions – inches/mm													Approximate Weight Each lbs/kg
Nominal Size inches mm	Actual Outside Diameter inches mm	Height A	Width B	Depth C	D	E	F	G	H	I	J	K	L	M	
2 ½ 65	2.875 73.0	69.11 1755.4	31.50 800.1	23.81 604.8	12.00 304.8	15.75 400.1	8.84 224.5	12.15 308.6	8.84 224.5	16.67 423.4	11.62 295.1	4.47 113.5	4.47 113.5	3.00 76.2	516.0 234.1
3 80	3.500 88.9	69.11 1755.4	31.50 800.1	23.81 604.8	12.00 304.8	15.75 400.1	8.84 224.5	12.15 308.6	8.84 224.5	16.67 423.4	11.62 295.1	5.57 141.5	5.57 141.5	3.00 76.2	522.0 236.8
4 100	4.500 114.3	69.11 1755.4	31.50 800.1	23.81 604.8	12.00 304.8	15.75 400.1	8.84 224.5	12.15 308.6	8.84 224.5	16.67 423.4	11.62 295.1	5.73 145.5	5.40 137.2	3.00 76.2	720.0 326.6
6 150	6.625 168.3	69.11 1755.4	31.50 800.1	23.81 604.8	12.00 304.8	15.75 400.1	8.84 224.5	12.15 308.6	8.84 224.5	16.67 423.4	11.62 295.1	3.85 97.8	3.85 97.8	3.00 76.2	840.0 381.0

FireLock® Fire-Pac

SERIES 745

COMPRESSOR REQUIREMENTS

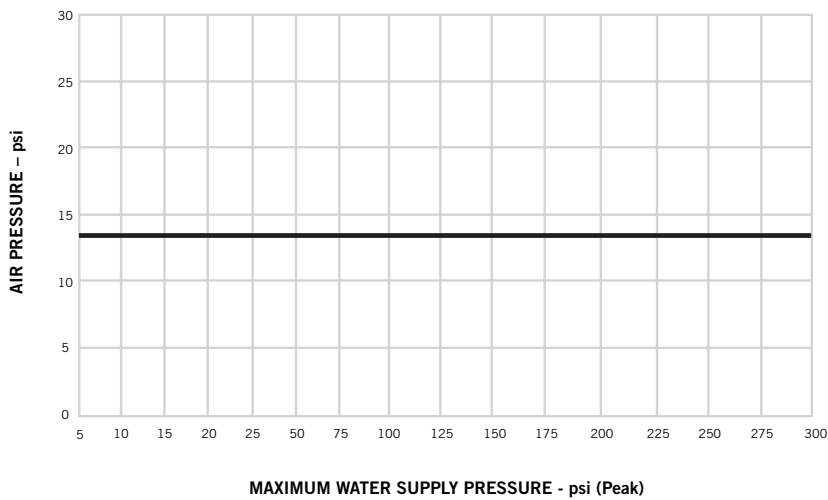
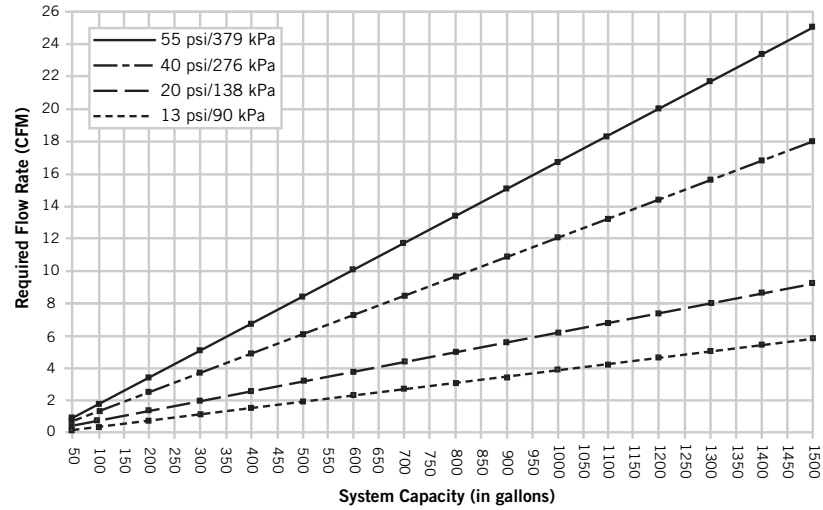

FireLock® Fire-Pac

SERIES 745

SERIES 745 FIRELOCK FIRE-PAC PANEL OPTIONS

- A** No panel (includes terminal block for wiring connections only).
- B** PDRP2001 Panel (w / 2-12v 12AH Battery). This option includes the base panel with two (2) 12 AH batteries. The base panel provides the alarm and Trouble relays. The Alarm indicates when the valve trips and the Trouble indicates a technical difficulty (i.e. Loss of power, loose wire, etc.) Three programmable relay contacts are provided for remote signaling.
- C** PDRP2001 Panel w / 4XTM. Option B. Plus a supervised output for local energy municipal box transmitter and alarm and trouble reverse polarity.
- D** PDRP2001 Panel w / 4XTM / ANN-80. Option C. Plus a remote LCD annunciator that mimics the information displayed on the FACP LCD display.
- E** PDRP2001 Panel w / 4XTM / ANN-I/O. Option C. Plus an LED Driver that can be used as an interface with the FACP to drive most customized graphic annunciators.
- F** PDRP2001 Panel w / 4XTM / ANN-RLY. Option C Plus 10 additional programmable Form-C relays.
- G** PDRP2001 Panel w / 4XTM / ANN-80 / ANN-I/O. Option D and E features combined.
- H** PDRP2001 Panel w / 4XTM / ANN-80 / ANN-RLY. Option D and F features combined
- I** PDRP2001 Panel w / 4XTM / ANN-I/O / ANN-RLY. Option E and F features combined
- J** PDRP2001 Panel w / ANN-80. Option B. Plus a remote LCD annunciator that mimics the information displayed on the FACP LCD display.
- K** PDRP2001 Panel w / ANN-80 / ANN-I/O. Option B. Plus a remote LCD annunciator that mimics the information displayed on the FACP LCD display, and an LED Driver that can be used as an interface with the FACP to drive most customized graphic annunciators.
- L** PDRP2001 Panel w / ANN-80 / ANN-RLY. Option B. Plus a remote LCD annunciator that mimics the information displayed on the FACP LCD display, and 10 additional programmable Form-C relays.
- M** PDRP2001 Panel w / ANN-80 / ANN-I/O / ANN-RLY. Option K. Plus 10 additional programmable Form-C relays.
- N** PDRP2001 Panel w / ANN-I/O. Option B. Plus an LED Driver that can be used as an interface with the FACP to drive most customized graphic annunciators.
- O** PDRP2001 Panel w / ANN-RLY. Option B. Plus 10 additional programmable Form-C relays.
- P** PDRP2001 Panel w / ANN-I/O / ANN-RLY. Option N and O features combined.
- 9** Special.

NOTES:

PDRP2001 (120 VOLT) Six Zone, 24-volt deluge-preaction control panel for single and dual hazard applications.
(PDRP2001E - 220 VOLT)

CAC-5X Optional. Used to convert Class B style wiring connections to Class A style.

4XTM Optional. Used to provide a supervised output for local energy municipal box transmitter and alarm and trouble reverse polarity.

ANN-80 Optional. Remote LCD annunciator that mimics the information displayed on the FACP LCD display.

ANN-I/O Optional. LED driver module provides a connection to a user supplied graphic annunciator.

ANN-RLY Optional. Provides 10 programmable Form-C relays which can be programmed for various functions; Alarm, Trouble, Supervisory, AC Loss, Waterflow Delay, Input Zones and Silenceable Alarm.

- **FACP** – Fire Alarm Control Panel
- **LCD** – Liquid Crystal Display
- **LED** – Light Emitting Diode
- **Class B** – 2-wire configuration
- **Class A** – 4-wire configuration

This product shall be manufactured by Victaulic or to Victaulic specifications. All products to be installed in accordance with current Victaulic installation/assembly instructions. Victaulic reserves the right to change product specifications, designs and standard equipment without notice and without incurring obligations.

Series 745 FireLock® Fire-Pac

FireLock Fire-Pac Figure Number System



Class	Type	Size	Style Number	Trim Selection	Panel Design	Applicable Wiring Code	Compressor Selection	Air Maintenance Selection	Color Selector
S	A - Dry D - Deluge P - Pre-Action	014 1 1/2" 020 2" 761 76.1 mm# 165 165.1 mm# 024 2 1/2" 030 3" 040 4" 060 6"	745	01 - Dry Actuated 1A - Dry Actuated with Added Control Valve 02 - Dry Actuated/Accelerated † 2A - Dry Actuated/Accelerated with Added Control Valve † 03 - Deluge Pneumatic 3A - Deluge Pneumatic with Added Control Valve 04 - Deluge Electric 4A - Deluge Electric with Added Control Valve 05 - Pre-Action Electric Single Interlock 5A - Pre-Action Electric Single Interlock with Added Control Valve 5B - Pre-Action Single Electric Auto Convert with Added Control Valve 5C - Pre-Action Single Electric Auto Convert with Added Control Valve 06A - Pre-Action Electric Double Interlock with Added Control Valve 6A - Pre-Action Electric Double Interlock with Added Control Valve 68A - Pre-Action Electric Double Auto Convert Dry 6C - Pre-Action Electric Double Auto Convert Dry with Added Control Valve 07 - Pre-Action Pneumatic/Electric Double Interlock 7A - Pre-Action Pneumatic/Electric Double Interlock with Added Control Valve 7B - Pre-Action/Double Interlock Electric-Pneumatic/Electric 7C - Pre-Action/Double Interlock Electric-Pneumatic/Electric with Added Control Valve 7D - Pre-Action Pneumatic Single Interlock 7E - Pre-Action Pneumatic Single Interlock with Added Control Valve 7F - Pre-Action Pneumatic/Electrical Double Auto Convert 7G - Pre-Action Pneumatic/Electric Double Auto Convert With Control Valve 7H - Pre-Action Pneumatic/Electric/Electric Double Auto Convert 7J - Pre-Action Elec/Pneum/Electric Double Auto Convert w/ Control Valve 08 - Pre-Action Pneumatic/Pneumatic 8A - Pre-Action Pneumatic/Pneumatic with Added Control Valve 09 - Special#	A - No Panel B - PDRP-2001 Panel (includes 2- 12V, 12AH Batteries) C - PDRP-2001 Panel / 4XTM D - PDRP-2001 Panel / 4XTM / ANN-80 E - PDRP-2001 Panel / 4XTM / ANN-IO F - PDRP-2001 Panel / 4XTM / ANN-RLY G - PDRP-2001 Panel / 4XTM / ANN-80 / ANN-IO H - PDRP-2001 Panel / 4XTM / ANN-80 / ANN-RLY I - PDRP-2001 Panel / 4XTM / ANN-IO / ANN-RLY J - PDRP-2001 Panel / ANN-80 K - PDRP-2001 Panel / ANN-80 / ANN-IO L - PDRP-2001 Panel / ANN-80 / ANN-RLY-10 M - PDRP-2001 Panel / ANN-80 / ANN-IO / ANN-RLY-10 N - PDRP-2001 Panel / ANN-IO P - PDRP-2001 Panel / ANN-RLY O - PDRP-2001 Panel / ANN-IO / ANN-RLY 9 - Special#	1 - Standard (US) UL - Class B 2 - Canada ULC - Class B 3 - US 220V - Class B 4 - Standard Class A 5 - Canadian - Class A 6 - 220V - Class A	B - 1/4 hp** C - 1/2 hp** D - 1/2 hp** E - 1/2 hp** F - 1/2 hp** G - 1 hp** H - None*** 9 - Special#	1 - Compressor, no AMT** 2 - Air Maintenance Trim Assembly (AMT Assembly) ***@ 3 - Air Maintenance Trim Assembly With Tank @ 4 - No Compressor 9 - Special #	1 - Red 9 - Special#

Contact Victaulic for pricing and availability
 ** Warning: Valve equipped with an accelerator requires Air Maintenance Trim
 † Electric release with panel cross-zoned
 †† Air Maintenance Trim without compressor is for use with external tank mounted air compressor or stop air
 ††† Electric release with panel cross-zoned
 @ When ordering Air Maintenance Trim along with the compressor, it must have a tank (option 3)
 † Requires regulated air maintenance trim assembly (option 3) with tank
 †† 2 1/2" - 6" Fire-Pacs Only
 ††† When 220v wiring code, compressor must be 3/4hp or none

FireLock® Fire-Pac

SERIES 745

INSTALLATION

Reference should always be made to the I-100 Victaulic Field Installation Handbook for the product you are installing. Handbooks are included with each shipment of Victaulic products for complete installation and assembly data, and are available in PDF format on our website at www.victaulic.com.

WARRANTY

Refer to the Warranty section of the current Price List or contact Victaulic for details.

NOTE

This product shall be manufactured by Victaulic or to Victaulic specifications. All products to be installed in accordance with current Victaulic installation/assembly instructions. Victaulic reserves the right to change product specifications, designs and standard equipment without notice and without incurring obligations.

For complete contact information, visit www.victaulic.com

30.23 3036 REV H UPDATED 1/2009

VICTAULIC IS A REGISTERED TRADEMARK OF VICTAULIC COMPANY. © 2009 VICTAULIC COMPANY. ALL RIGHTS RESERVED.

30.23

